

REVISIONS		
NO.	DESCRIPTION	DATE

**CONTRACTOR SHALL KEEP  
11' MINIMUM LANES UNLESS  
NOTED OTHERWISE.**

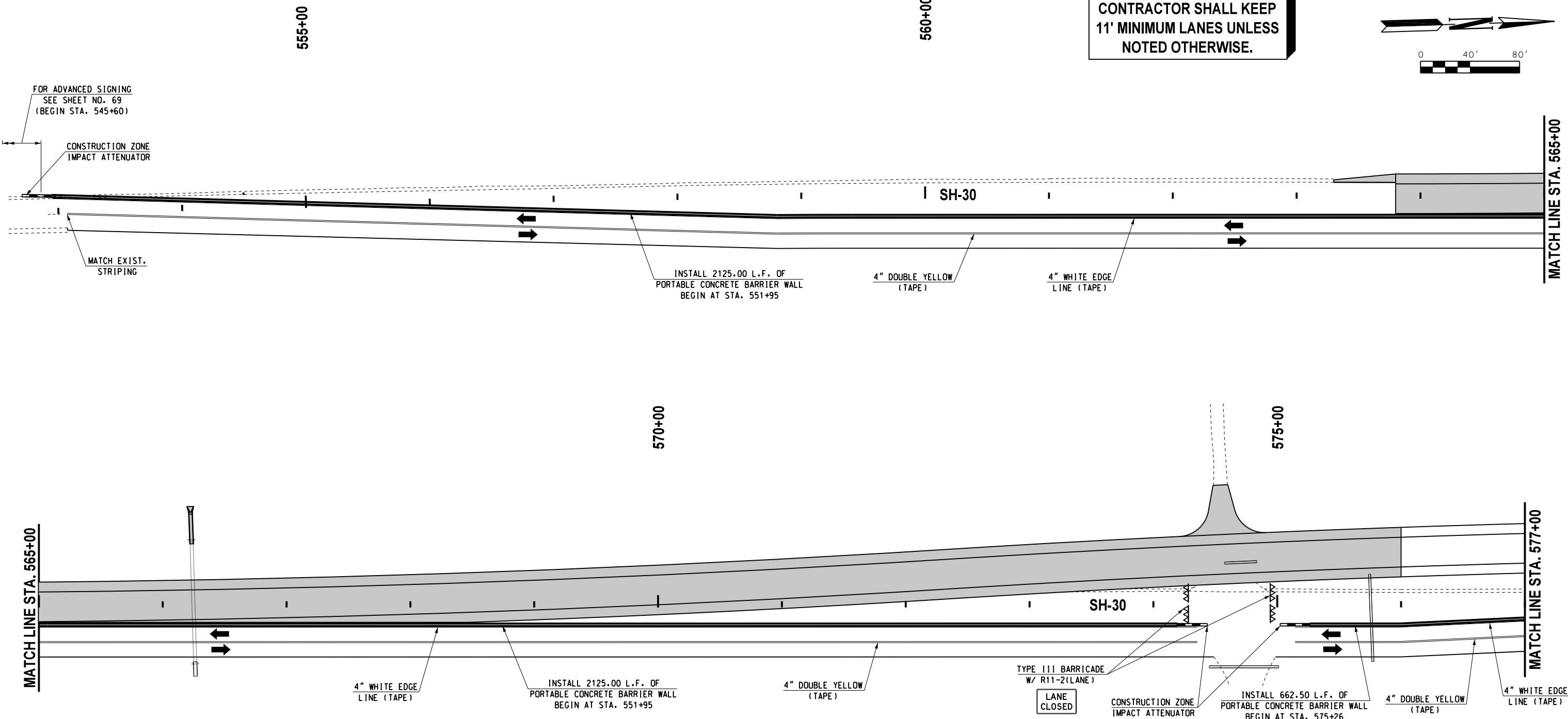
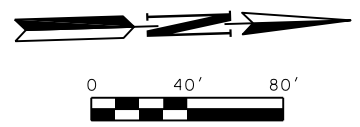

**SUGGESTED SEQUENCE OF CONSTRUCTION**

- PHASE 3. SHIFT TRAFFIC EAST TO TEMP. ASPHALT WIDENING OF SH-30 (ONE LANE EACH DIRECTION)
- PLACE PORTABLE LONGITUDINAL BARRIER ALONG WEST EDGE OF DETOURED SOUTHBOUND LANE
  - CONSTRUCT WEST HALF OF NEW SH-30 PAVING AND DRAINAGE, TYING TO EXIST PAVEMENT (C.R.L. SH-30 STA. 563+79.97 TO STA. 576+00 AND STA. 596+00 TO STA. 613+00)
  - CONSTRUCT EW150 ROAD

LEGEND	
	- TYPE III BARRICADE W/ TWO TYPE "A" LIGHTS
	- DRUM
	- CHANNELIZER CONE
	- PORTABLE CONC. BARRIER WALL
	- CONSTRUCTION ZONE IMPACT ATTENUATOR
	- WORK AREA

Design	RWR	9/13/2016
Drawn	CCC	9/13/2016

TRAFFIC CONTROL PLANS  
PHASE 3  
(1 OF 3)  
State Job No. 28768(04) Sheet No. 72

9/13/2016 G:\00\Projects\1-2356 SH 30 over Salt Fork of Red River\CAD\TC PHASE 3ABCD - Ldgn

S.H. 30 BRIDGE & APPROACHES HARMON COUNTY